

Hand-push Floor Scrubber

Operation Instruction

XMD 50/50

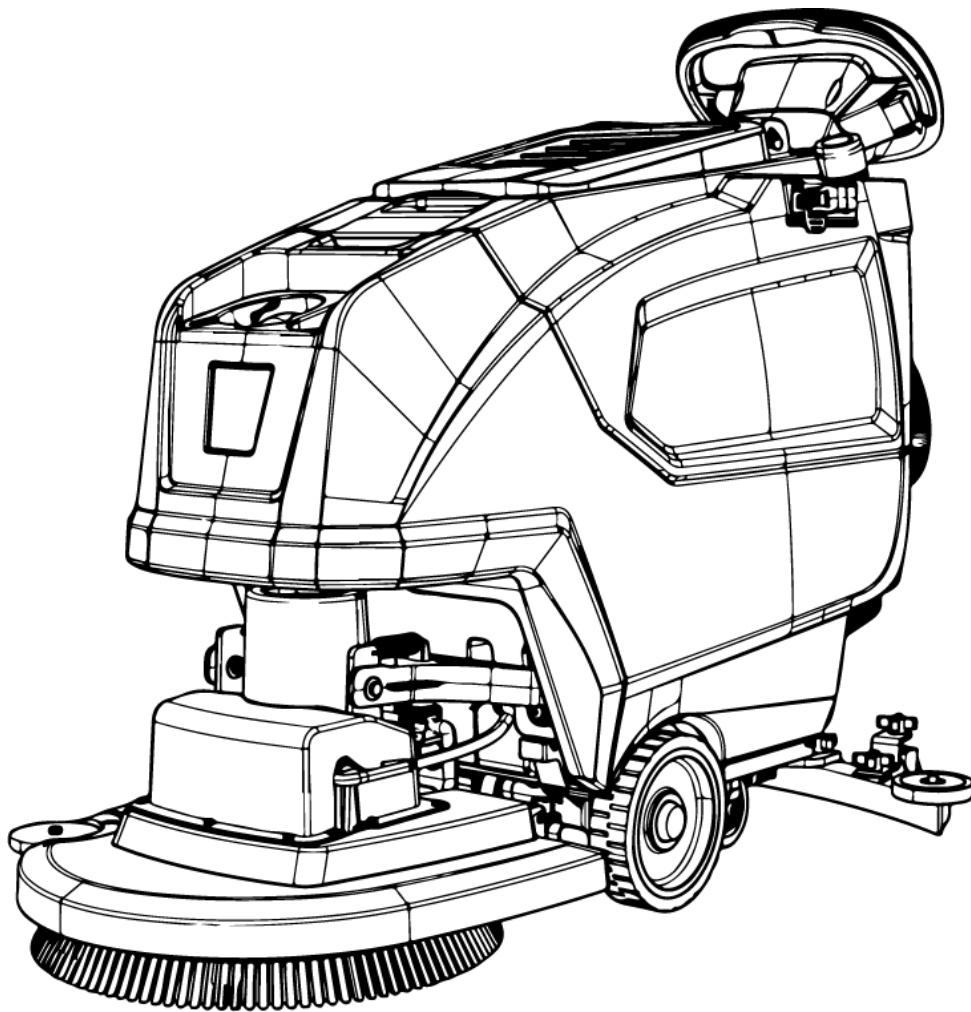

It is strictly prohibited to use this equipment without reading this manual.

Preface

Thank you for choosing Chancee cleaning equipment. We are confident in providing you with this product which is manufactured using the latest technology and has undergone strict quality control. This manual is used to help you understand the operation and maintenance of the equipment so that you can use it more comfortably and efficiently, so please read this manual thoroughly before using.

Safety Precautions

To ensure safety, please follow the following important usage rules!

1. Do not use this device while under the influence of alcohol or medication.
2. Before any maintenance and repair, please turn the machine OFF, and please remove the key from the main power switch and keep it properly.
3. This machine must be used by qualified and authorized personnel. Minors and disabled persons are not allowed to use it.
4. Keep batteries away from sparks, flames and smoke.
5. It is prohibited to use the machine in places with dangerous, flammable or explosive gases, liquids and water vapors.
6. No loose clothing or accessories are allowed. Keep clothing, gloves and hair away from moving parts.
7. Do not smoke while the battery is charging.
8. In case of fire, please use dry powder fire extinguisher, instead of water to extinguish the fire.
9. When a machine is scrapped, accessories containing hazardous substances (such as batteries, waste oil, etc.) shall be sent to a specific center for disposal.

Safe use-must read

1. Before using the equipment, please read this user manual carefully. This will ensure that you understand the control and maintenance requirements and help you use the equipment safely.
2. If the machine is handed over to other people, please be sure to hand over the instruction manual as well and tell them to read it carefully before use.



When reading this user manual



This manual includes all configurations for this series of products, therefore, you may find that some of the information does not apply to your device.

All information, specifications and illustrations in this manual are effective when this manual is published. Our company reserves the right to change specifications or designs without prior notice.

In this manual, we use the symbol  with the word "Warning" to indicate the possibility of a hazard that may result in death or serious personal injury; in order to avoid or reduce the hazard, the relevant steps must be strictly followed.

In this manual, we use the symbol  with the word "Caution" indicates the possibility of dangers that may cause minor or moderate personal injury or equipment damage; in order to avoid or reduce the danger, the relevant steps must be strictly followed.

( ) A mark similar to this indicates that the direction to which the arrow points is forward.

( ) An arrow similar to this indicates movement or action.

Contents

Chapter 1 Product Introduction	1
1.1 Applicable Scenarios	1
1.2 Equipment Overview	1
1.3 Control Panel/Buttons	2
1.4 Technical parameters	3
1.5 Accessories list	3
1.6 Consumables and Optional Accessories	3
Chapter 2 Installation	4
2.1 Unloading	4
2.2 Installation	4
2.2.1 Squeegee installation	4
2.2.2 Connecting the battery cables	4
Chapter 3 Inspection before use	6
3.1 Check the battery	6
3.2 Check clean water level	6
3.3 Check sewage level	6
3.4 Check the wear of the brush	6
3.5 Check the wear of the rubber strips	6
Chapter 4 Operation instructions	7
4.1 Before operation	7
4.2 Scrubbing	7
4.3 Sewage draining	8
4.4 Shutting down	8
4.5 Charging	8
Chapter 5 Cleaning and maintenance	10
5.1 Cleaning	10
5.2 Maintenance	10
5.2.1 Replacement and installation of brush plate	10
5.2.2 Replacement and installation of rubber strips	11
5.2.3 Adjustment of squeegee	12
Chapter 6 Transportation and Storage	13
6.1 Transportation	13
6.2 Storage	13
Chapter 7 Common faults	14
Warranty Card	16

Chapter 1 Product Introduction

1.1 Applicable Scenarios

This equipment can be used in a variety of scenarios, including commercial and industrial places , such as hotels, schools, hospitals, industrial offices, supermarkets, office buildings, etc.; for epoxy floors, PVC floors, terrazzo, wear-resistant floors, tiles and cement floors , wooden floors, rubber floors, different floors can be cleaned with brush plates made of different materials.

1.2 Equipment Overview

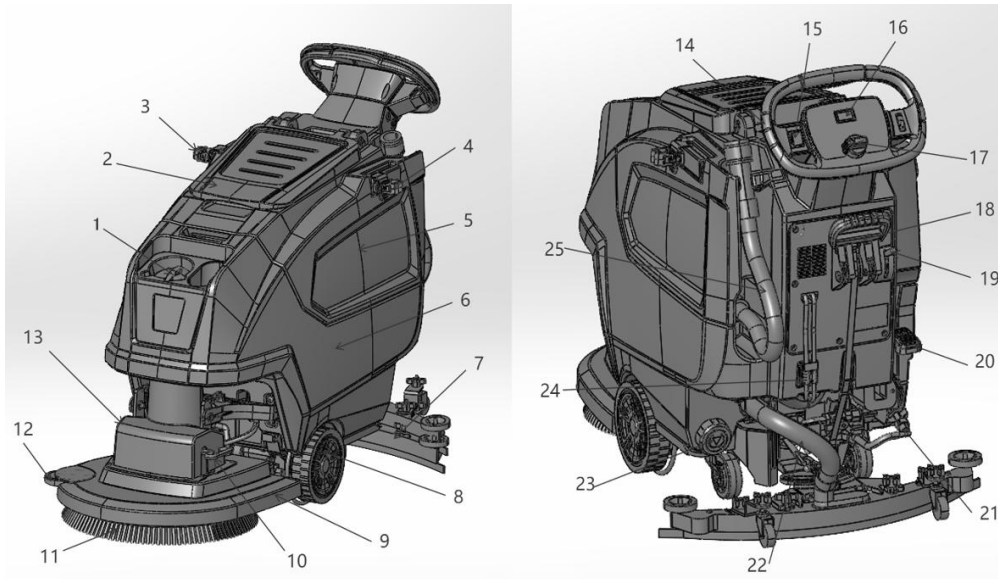

NO.	NAME	FUNCTION	NO.	NAME	FUNCTION
1	Clean water inlet cover	Avoid sundries drop into the clean water tank	14	Driving Wheel	Control machine driving direction
2	Sewage tank cover	Seal the sewage tank	15	Power switch	Turn on/off the machine
3	Hook	For placing rag, cable, bag, etc	16	Display screen	display working status and power percentage
4	Mop clip	For placing mop	17	Function knob	Control suction and brush
5	Sewage tank	Sewage storage	18	Lifting handle	Lift and drop squeegee
6	Clean water tank	Clean water storage	19	Outlet clean water valve	Control the amount of outlet clean water
7	Squeegee	Collect sewage on the floor	20	Brush pedal	Lift and drop brush plate
8	Main wheel	For supporting	21	Clean water outlet	Outlet clean water to the center area of brush plate
9	Brush plate	Cover and protect brush plate	22	Sewage hose	Hose connect squeegee and sewage

	cover				tank
10	Brush plate remover	Remove the brush plate from the machine	23	Clean water drain port	Drain the clean water tank
11	Brush plate	Brush and clean the floor	24	Charging port	For machine charging
12	Fender wheel	Avoid crash and damage the machine	25	Sewage outlet hose	Drain the sewage tank
13	Motor cover	Cover the motor of brush plate			

1.3 Control Panel/Buttons

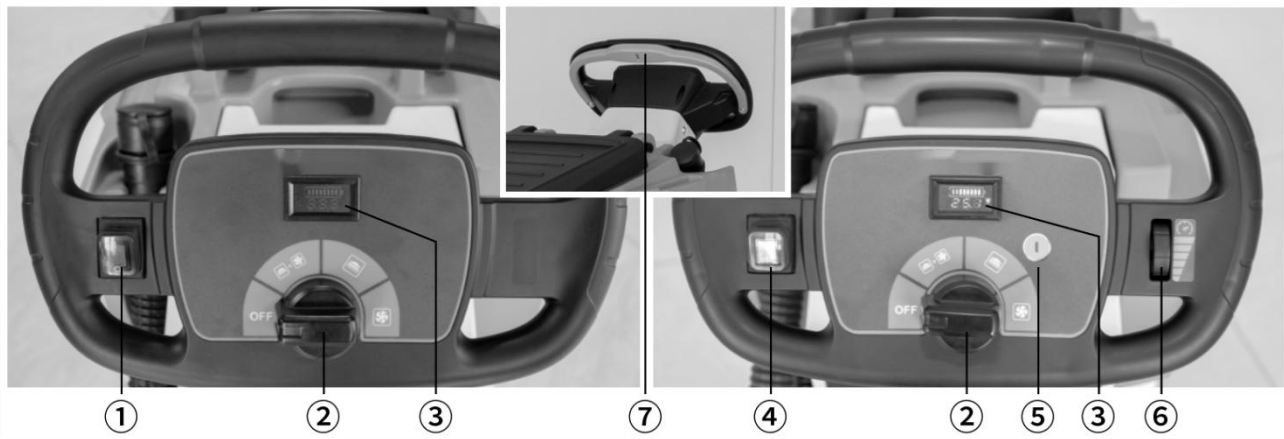

No.	Name	Function
①	Power switch button	Turn on/off the machine
②	Function knob	Start and stop the suction and brush
③	Coulomb meter	Display the current voltage of the machine
④	Forward/backward	Driving forward or backward(self propelled)
⑤	Key hole	Power on/off the battery(self propelled)
⑥	Speed controller	Control the moving speed(self propelled)
⑦	Self propelled rod	Start the self propelled mode(self propelled)

1.4 Technical parameters

Name	Manual	Self propelled	Name	Manual	Self propelled
Clean width (mm)		520	Brush plate motor power (W)		550
Squeegee width (mm)		825	Driving motor power (W)	/	100
Continual working time (h)		3	Clean water tank (L)		45
Theoretical working efficiency (m ² /h)		2800	Sewage tank (L)		50
Battery capacity (V/Ah)	24/80 (maintenance-free) 24/100 (maintenance-free) 24/140 (maintenance-free) 24/140 (Lithium battery)		Total weight (kg)		138
Suction motor power (W)		300	Working size (mm)		1400*825*1040

1.5 Accessories list

When you open the packaging box, you will find that it contains the following components. Please check the components listed in the table. If there are anything missing, please contact us in time.

No.	Name	Qty	No.	Name	Qty
①	Main machine	1	④	Tool kit	1
②	Charger	1	⑤	Operation instruction	1
③	Squeegee components	1	⑥	Warranty card	1

1.6 Consumables and Optional Accessories

The consumables of this equipment are listed in the table below. When any of them is worn, you need to purchase and replace it; This equipment can cope with different scenarios through different optional accessories, which you can purchase through suppliers or manufacturers.

Consumables	Optional accessories
Brush plate, squeegee rubber	Lithium battery, maintenance-free battery, clean pad, clean pad plate

Chapter 2 Installation

2.1 Unloading

⚠ Caution:

Please remove the outer packaging carefully to avoid damaging the machine shell;
It is recommended to keep the packaging boxes of related products after receiving the goods, so that the machine can be repackaged later when the equipment is moved or returned or exchanged;
It is prohibited to violently unload the machine from the pallet to avoid damaging the parts;
Place the unloading wooden pallet, remove the wooden blocks that fix the big wheels, and then move the machine backwards to unload the equipment from the pallet.

2.2 Installation

2.2.1 Squeegee installation

Step 1: Pull down the Squeegee lifting handle, and lowered the Squeegee tail to the ground;

Step 2: The Squeegee pick fixed screw through the Squeegee tail hole eye, use the plastic knob to Tighten

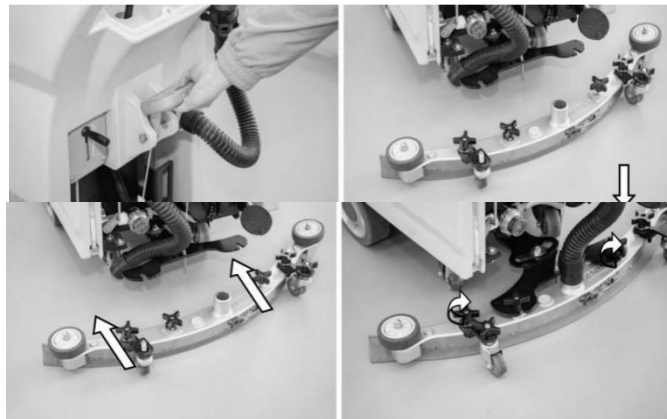

Step 3: Insert the other end of the suction tube into the suction port of the squeegee to complete the installation.

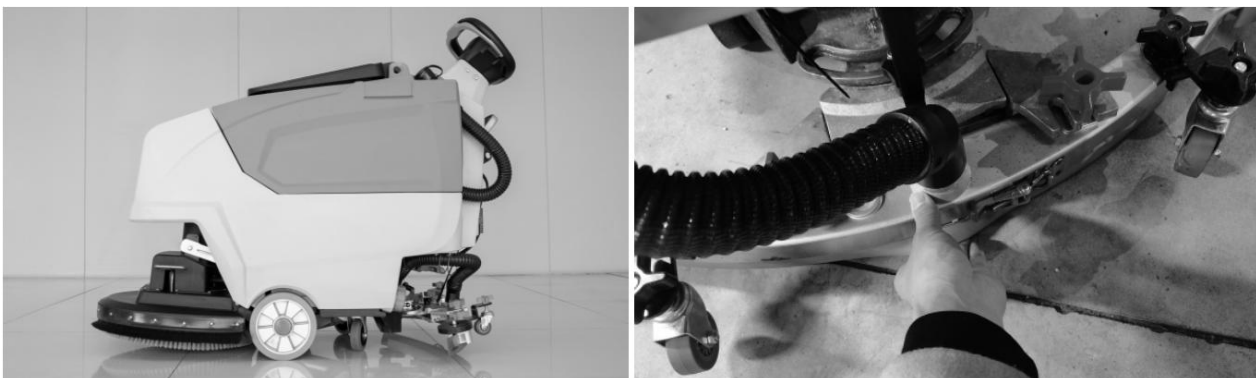

2.2.2 Connecting the battery cables

Step 1: Lift the sewage tank and check whether the wire harness on the battery is connected and tightened;

Step 2: Connect the disconnected battery poles in series. Note that the positive (+) port is red and the negative (-) port is black.

After the connection is completed, put down the sewage tank.

⚠ Caution: Due to the different distances of logistics routes, in order to avoid battery loss during long journeys, the battery cables have been disconnected at the factory.



Chapter 3 Inspection before use

3.1 Check the battery

After turning on the power key switch, the battery meter will display the current voltage of the battery. When the voltage is about 22V or there's one last bar, please charge it in time.

⚠ Caution:

During the use of the battery, deep discharge will cause the battery capacity to decrease and its life to be shortened. For example: the battery is often used below 22V and is not charged in time.



3.2 Check clean water level

⚠ Caution:

Please observe water level in the solution tank through the clean water level tube, ensure that there is sufficient water, and avoid using the suction motor when there is no water. Otherwise, the motor may take in dust. In severe cases, the noise of the suction motor will become louder or the suction power will be insufficient.

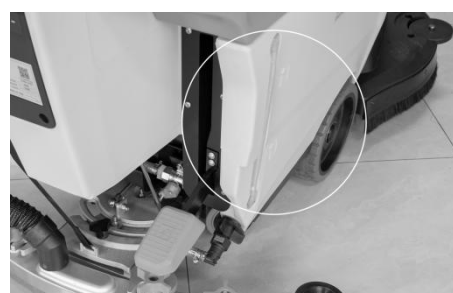

3.3 Check sewage level

⚠ Caution:

Open the sewage tank cover, if the floating ball is in a high position already, please drain the sewage in time, otherwise, continual usage may bring water in and damage the motor.

3.4 Check the wear of the brush

Place the brush plate on the ground. If the length of the bristles (root to ground) is less than 1.5cm, please replace the brush in time.

3.5 Check the wear of the rubber strips

Check whether the strips are damaged, deformed, aged or cracked. If so, please replace them in time.

⚠ Caution:

When the machine moving backward, turn off the suction button and lift the squeegee to prevent deformation of the rubber strips and squeegee sheet metal parts.



Chapter 4 Operation instructions

4.1 Before operation

Make sure the squeegee and sewage hose are installed correctly before operating the machine.

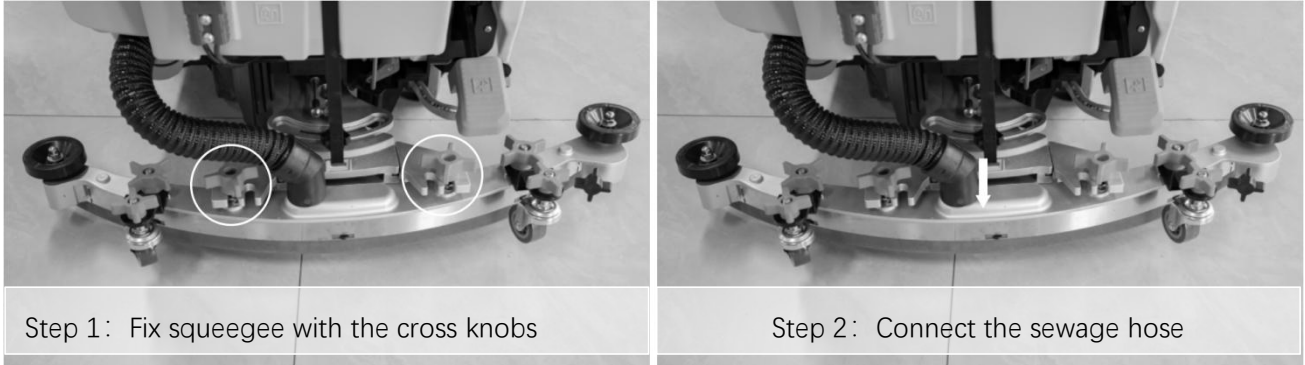

⚠ Caution:

When the machine moving backward or transfer between application areas, turn off the suction button and lift the squeegee to prevent deformation of the rubber strips and squeegee sheet metal parts.

4.2 Scrubbing

- Step 1: Step the brush pedal to land the brush plate on the floor;
- Step 2: Pull the lifting handle to land the squeegee on the floor;
- Step 3: Power on, switch and choose the cleaning function required;
- Step 4: Turn on and adjust clean water outlet valve;
- Step 5: Hold the driving wheel and propelled rod to start the cleaning.



⚠ Caution: Avoid stopping the machine in the same place for a long time with the brush plate working, as this will leave unnecessary marks on the floor.

4.3 Sewage draining

Step 1: Push the machine to a site that meets the sewage discharge standards, stop the machine and turn off the power;

Step 2: Remove the sewage hose from the clamp at the rear of the machine, place it downwards, open the tube cover, and drain sewage. The inner wall of the sewage tank can be appropriately rinsed with clean water.



⚠ Caution: When flushing the sewage tank, do not splash water into the suction port to prevent the suction motor from burning out.

4.4 Shutting down

Step 1: Empty both tanks;

Step 2: Stop and park on flat ground;

Step 3: Turn off the machine and cleaning functions and remove the key;

Step 4: Lift brush plate and squeegee.

⚠ Caution: If the machine will not be used for a long time, it needs to be fully charged in advance and disconnect the connecting wires on the battery and wrap them with insulating tape to prevent the battery from losing power due to long-term non-use.

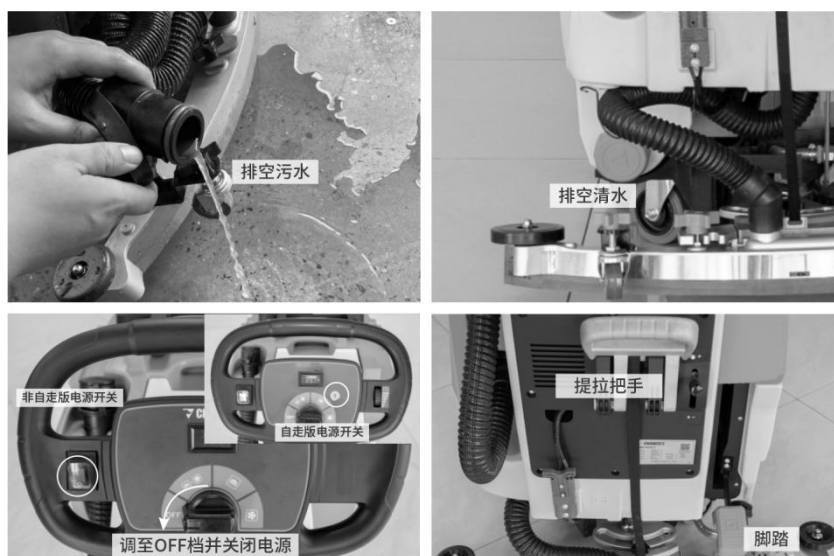

4.5 Charging

The right way for charging:

Connect battery first then power socket for charging, disconnect power socket first then battery when fully charged.

· The power system of this floor scrubber is composed of two 12V maintenance-free lead-acid batteries or two 12V liquid-filled batteries or one piece of 24V lithium battery connected in series, and the system voltage is 24V;

· When the machine has been operating for a period of time, the battery power



will drop. When the last two bars of the power meter are red, or the voltage is lower than 21V, it means that the power is insufficient and needs to be charged in time;

- When maintaining the battery, please wear protective gloves to avoid contact with acidic substances of the battery;
- Check whether the battery connection wire is worn and whether the contacts are loose, and replace it if necessary;
- The battery terminals should be kept clean and dry, without debris and dust covering them, otherwise it will be extremely detrimental to the battery, and in serious cases, it will burn the battery;
- In order to ensure that the battery has a long service life, it should be charged in time after the machine finishes working, and deep discharge is strictly prohibited;
- When the machine is not used for a long time/over 15 days, please fully charge the battery and store the battery with the positive pole (+) disconnected.

 **Caution:**

When use battery, deep discharging will reduce its capacity and shorten its service life. For example, keep working under 21V and not charge in time. If the machine will not be used for a long time, it needs to be fully charged in advance and disconnect the connecting wires on the battery and wrap them with insulating tape to prevent the battery from losing power due to long time no using.

Chapter 5 Cleaning and maintenance

Proper cleaning and maintenance will increase the service life of your machine, so please check and clean the machine regularly.

5.1 Cleaning

- . Check and clean the wheel set and remove entangled objects;
- . Clean the sewage tank and tubes regularly, and use water to flush the dirt in the tank and blockages in the tubes;
- . Clean the dirt under the rubber strips regularly, and wipe the strips with a cotton rag;
- . Check the water filter regularly. When there are impurities in the transparent cover, rotate and unscrew the cover, and rinse it and the filter screen repeatedly with clean water.

⚠ Caution:

The machine is not a tightly waterproof device, so do not flush the machine directly with water. In that case, it may cause a short circuit in your machine or burn out the original electrical components.



5.2 Maintenance

5.2.1 Replacement and installation of brush plate

Step 1: Park the machine on a flat ground, step brush pedal and lift the brush plate, turn off the machine and make sure the machine is power off while replacing brush plate;

Step 2: Step on the brush plate remover to disconnect the brush plate and the machine;

Step 3: For installation, place the brush plate right under the flange of the machine and step the brush plate pedal for connection, and complete the installation with a soft step on the brush plate cover.

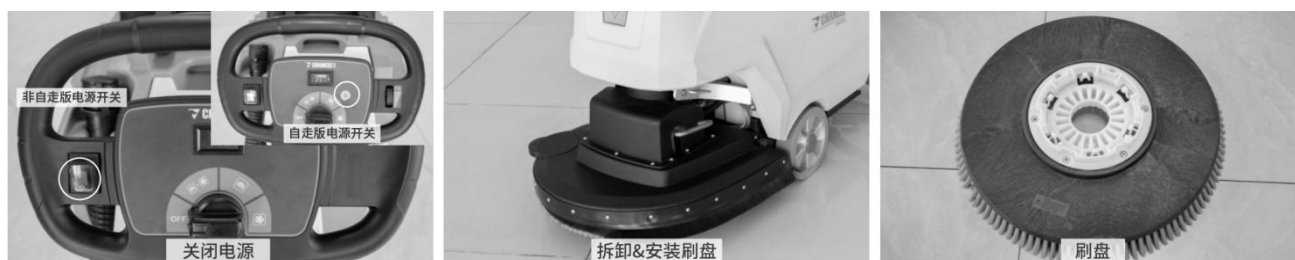

5.2.2 Replacement and installation of rubber strips

Step 1: Park the machine on a flat ground, turn off the machine and make sure the machine is power off while replacing;

Step 2: Rotate the plastic cross knob anti clockwise to loose the squeegee components;

Step 3: Loosen the nut to remove the squeegee plate and front and back rubber strips.

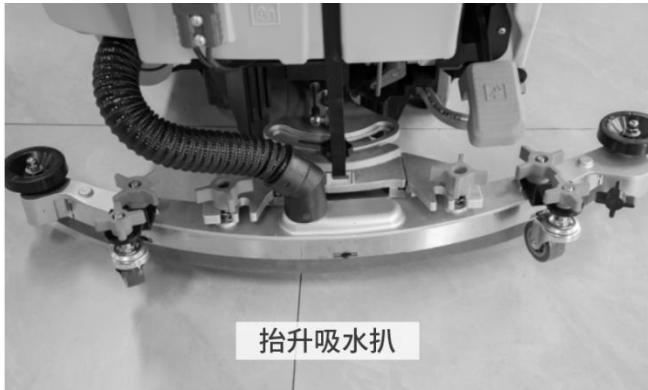

Remove the squeegee rubber strips

Step 1: Unscrew the knob on the squeegee plate and remove the universal wheel;

Step 2: Pull the buckle to loose and remove the rubber strips clamping plate, then remove the back rubber strip from the squeegee plate;

Step 3: Remove the bottom plate and also the front rubber strip.

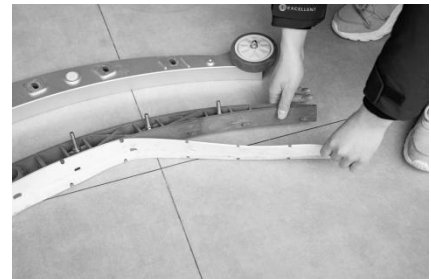

Step 1

Step 2

Step 3

Installation of rubber strips

Step 1: Align the holes of the front rubber strip with the teeth of plastic bottom plate, then fix the bottom plate on the squeegee plate;

Step 2: Align the holes of the back rubber strip with the teeth of the other side of the squeegee plate;

Step 3: Install the rubber strips clamping plate and lock the buckle;

Step 4: Screw on the knobs on the squeegee plate and install the universal wheels.

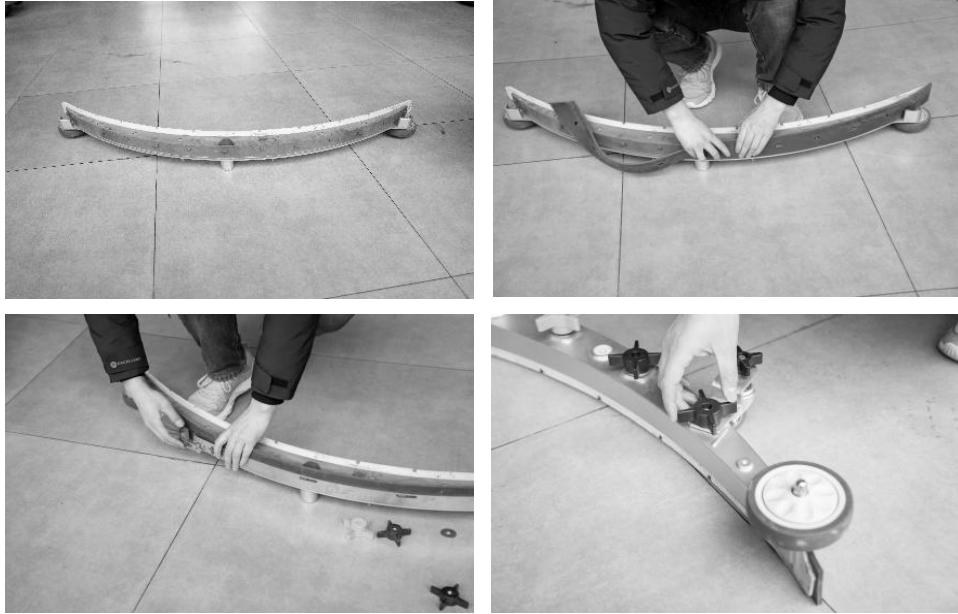

5.2.3 Adjustment of squeegee

Step 1: Place the assembled squeegee on the flat ground, adjust the height of the universal wheels and make it 3-5mm higher than the bottom side of the rubber strips on both sides;

Step 2: Connect the squeegee with the machine, turn on the scrubber function and drop the squeegee on the floor, then turn off the machine and check whether the squeegee is parallel to the floor;

Step 3: If not parallel, rotate the adjusting knob on the squeegee plate until the squeegee is parallel and completed contact with the floor;

Step 4: When it is found the squeegee tilts during scrubbing, please adjust by above steps.



Chapter 6 Transportation and Storage

6.1 Transportation

If the machine and the accessories need to be lifted, it is recommended that you put them on a pallet and lift them with a forklift. And water in both tanks must be emptied when transporting the machine;

In order to prevent slipping and damage caused by collisions during transportation, please ensure that the binding should be firm and the center of gravity should be stable to ensure safety. For transportation vehicles whose surfaces are in contact with the machine, both surfaces should be packed with soft pads or hard cardboard;

Carefully load and unload. Do not let the machine fall, roll, be pressed, etc. or turned upside down.

6.2 Storage

Before storing the machine, clean the machine, see [Chapter 5.1 Cleaning] for details;

For machines that will not be used for a long time, anti-rust treatment should be done before storage. Check the easily corroded parts, and apply butter;

If the machine will not be used within 7 days, store the machine fully charged in a clean, dry and away from flammable places;

If the machine will not be used for a long time, fully charge the battery first, then disconnect the battery connector, and store the battery at room temperature above 0 degrees. It is required to charge it once a month;

In areas with lower temperatures, clean water and sewage need to be emptied to prevent the tanks from cracking due to water freezing.

Chapter 7 Common faults

Fault	Phenomenon/Part	Troubleshooting	Solution
Charging failure	Charger failure	If the charger is not connected to the machine, see whether the green light will be on. If the machine is plugged in, the red light is on, and the built-in fan of the charger does not run	Replace the charger
	Charging interface oxidation	Whether there is any obvious oxidation trace on the copper interface	Clean the charging interface oxide
Suction motor not working	Switch	Turn on the switch and check if the switch light is on	Replace the switch
	Connector	Check whether the connector is tightly inserted or has fallen off	Reconnect and tighten the connector
	Controller	Check whether the controller screws and terminals are tight	Contact customer service center
	Suction motor	Use a multimeter to measure whether there is voltage at the input end of the suction motor	
Brush motor not working	Switch	Turn on the switch and check if the switch light is on	Replace the switch
	Connector	Check whether the connector is tightly inserted or has fallen off	Tighten the connector
	Controller	Check whether the controller screws and terminals are tight	Contact customer service center
	Brush motor	Use a multimeter to measure whether there is voltage at the input end of the brush motor	
Water not coming out	Clean water tube	Whether there is any scale in the transparent clean water tube	Clean clean water tube
	Filter	Whether there is dirt on the filter	Clean filter
	Solenoid valve	Measure whether the solenoid valve has input voltage	Check the input voltage of the solenoid valve. If it is normal, remove it and clean the blocked part. Replace the solenoid valve if necessary.

Loud noise	Resonance of rubber strips and sewage suction port	1. Is there any abnormal sound when the rubber strips are lifted? 2. Is there any obvious vibration in the water absorbing tube?	Adjust the height of the squeegee universal wheels
	Suction motor	1. Is there any abnormal sound when the rubber strips are lifted? 2. Is there still any abnormal sound after the water absorbing tube is pulled out?	Replace the suction motor
Brush plate	Frequent drop	Has the brush plate been lowered to the ground before turning on the switch?	This behavior is an incorrect operation and may easily cause the brush plate buckle to wear. Replace the buckle when necessary.
	Worn brush plate buckle	Observe the wear	Replace the brush plate buckle
The machine not sucking water properly	Floating ball cage clogged	Check the floating balls in the cage	Need extra attention in daily use
	Tube blocked	Clean the water suction tube	Need daily cleaning and maintenance
	Recovery tank sealing circle	Sealing circle aging	Replace accessories
	Squeegee	1. Whether the strips are cracked, aged or deformed 2. Whether the strips are wavy	1. Adjust the angle of the squeegee and the height of the universal wheel of the squeegee; 2. Replace the rubber strips
Machine can not moving	Solenoid brake	Check the solenoid brake gear when the machine is turned off to see if it is not the downward gear	Contact customer service center
	Accelerator pedal	1. Shortly connect the accelerator pedal connector plug. If the machine can move, there is something wrong with the accelerator pedal. 2. The fault light flashes 7 times.	
	Controller	Use a multimeter to measure whether there is input voltage to the controller	
	Driving axle	Use a multimeter to measure whether there is input voltage to the driving axle	

Warranty Card

Client Name		Telephone	
Mail address		Bill No.	
Purchase time		Machine Code	
Product model		Date	
Replace accessories			
Faults description			